

Robot Unit specifications

Item	Specifications	
	1R	2R
Robot loadable quantity	1	2
Power	Single phase / three phase 200 to 230 V ±10%, 50/60 Hz	
IO signal wires	8 inputs, 8 outputs <small>Maximum with extension 232 inputs, 232 outputs</small>	8 inputs, 8 outputs <small>Maximum with extension 232 x 2 inputs, 232 x 2 outputs</small>
Base weight	190 kg	250 kg
Operation panel	12 inch LCD touchscreen	
Excess voltage category	III	
Pollution degree	2	
Protection class	IP2x	
Power	0.33 kVA	0.62 kVA
Noise level	70 dB or less	

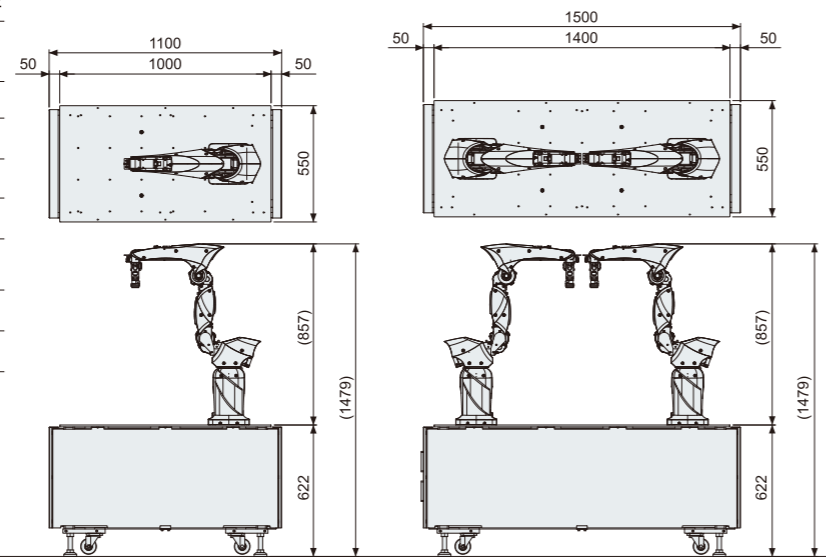

End effector attachment section

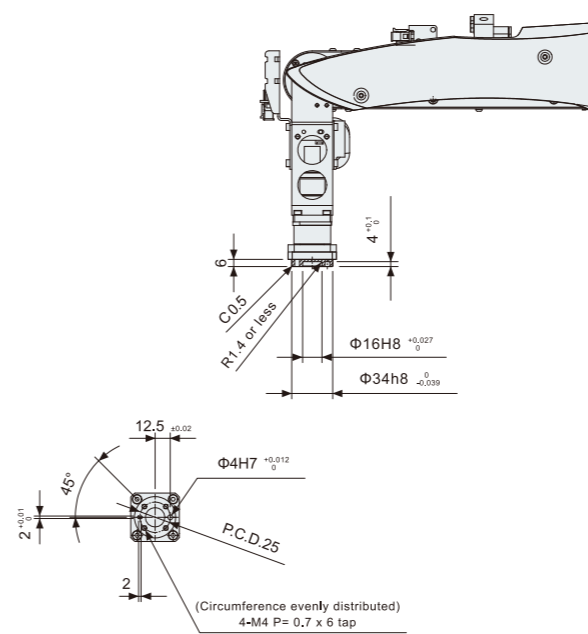

Operation panel specifications

Item	Specifications
Size	307 x 108.6 x 340 (includes EMERGENCY STOP button)
Monitor size	12 inch LCD touchscreen
Weight	6 kg
Attachment section	M4 x 4 locations, screw pitch: 100 x 100 mm (VESA 100 standard)
Included cable length	3 m

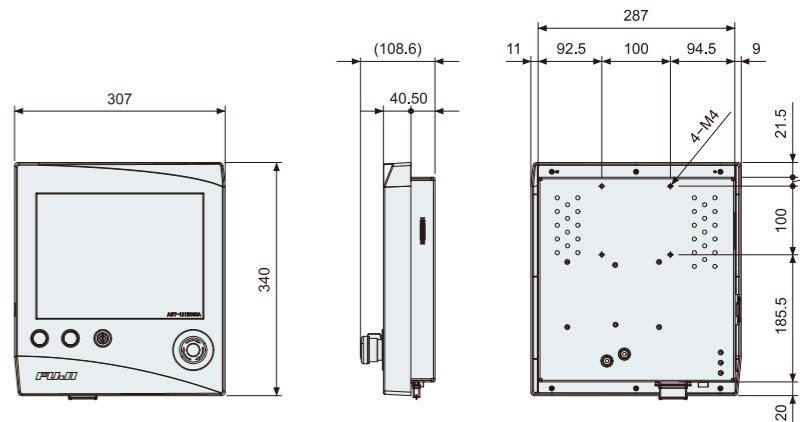

Robot arm specifications

Item	Specifications
Degrees of freedom	5
Maximum transportable weight *1	2kg
Movement method	AC servos
Position repeatability accuracy	±0.05 mm
Absolute positional accuracy *2	±0.3 mm
Maximum reach *3	712 mm
Air tubes	4 systems (φ4 x 4, inlet: Front J1 axis, outlet: Upper J4 axis, M5 type joint)
Wrist camera	Color camera, field of view: 100 x 100 mm, 2 million pixels
IO signal wires	10 cores (possible to be used by the user, connector shape: 1-1138114-6 by TE Connectivity) + 2 cores (for camera lighting) *4
Robot weight	25 kg

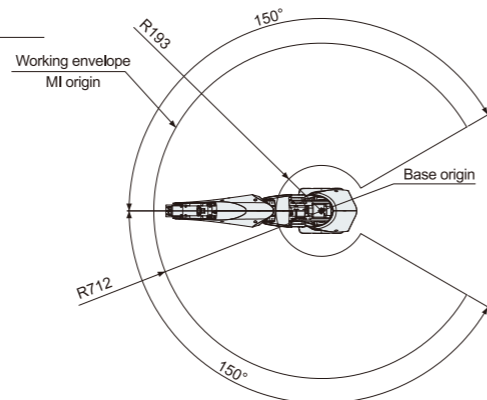
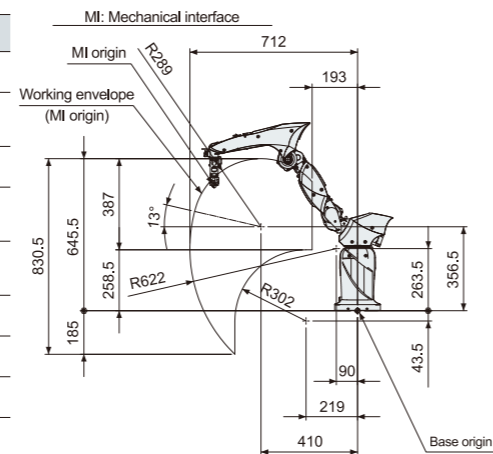

*1: Includes the weight of the end effector.
 *2: Measurement conditions under Fuji settings.
 *3: Mechanical interface working envelope.
 *4: Lighting is an option.

Wiring and piping connection sections

Pin names for [EE-CN1]	Connection	Pin names for [EE-CN2]	Permissible voltage and current
A1	↔	A1	30V/1.5A (at 40 degrees Celsius)
B1	↔	B1	
A2	↔	A2	
B2	↔	B2	
A3	↔	A3	
B3	↔	B3	
A4	↔	A4	
B4	↔	B4	
A5	↔	A5	
B5	↔	B5	
A6	↔	A6	
B6	↔	B6	

Connector	Model	Manufacturer
[EE-CN1]	1-1318114-6	TE Connectivity
[EE-CN2]		

